

ITEM

GBA.105.0001. xx

GBA.105.0003. xx

GBA.105.00WR. xx

GBA.105.0ETD. xx

COMBINATION PAPER TOWEL ROLL DISPENSER / WASTE UNIT:

RECESSED UNIT WITH WASTE UNIT FOR CONVERTIBLE COMBINATION

PAPER TOWEL ROLL DISPENSER

REMOVABLE WASTE RECEPTACLE - NOT INCLUDED

REMOVABLE AUTOMATIC ROLL DISPENSER - NOT INCLUDED



□ Outer surface
■ Inner surface

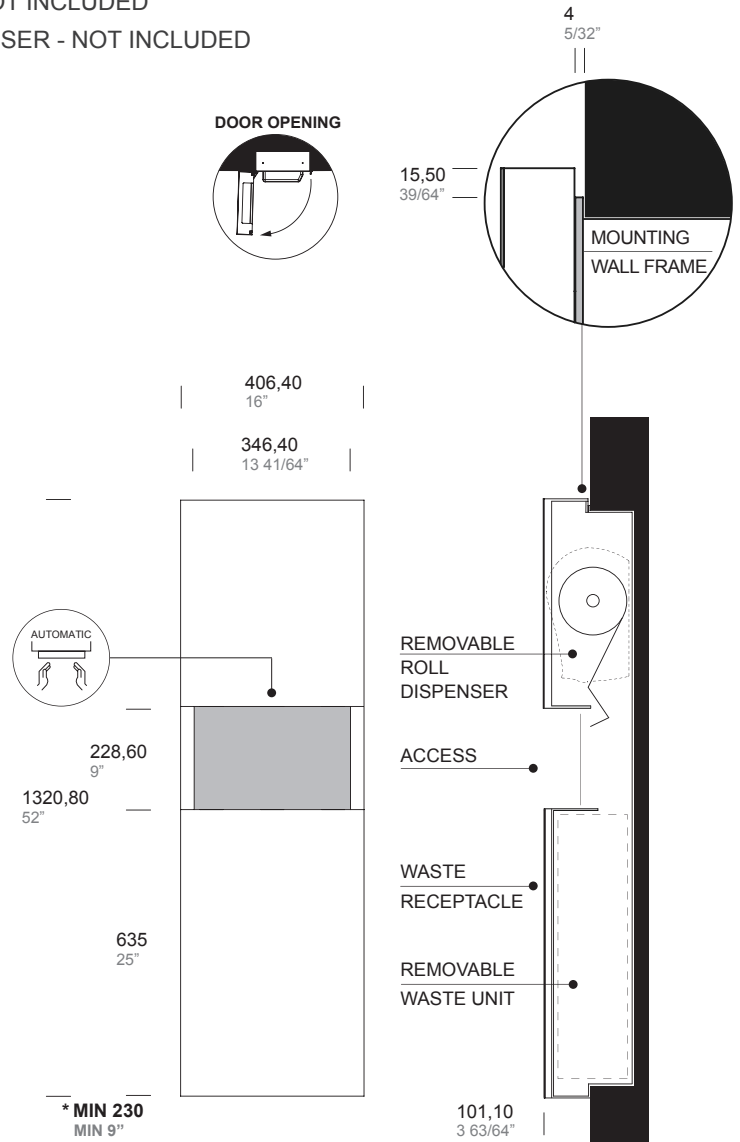

.XX STANDARD COMBINATION FINISHES OUTER AND INNER SURFACE

| | SATIN | POWDER COATED | | | | |
|---------------------------------|---------------|---------------|-----|-----|-----|-----|
| | .44 | .31 | .38 | .39 | .32 | .40 |
| □ OUTER | | | | | | |
| | POWDER COATED | .31 | .38 | .39 | .32 | .40 |
| ■ INNER AND MOUNTING WALL FRAME | | | | | | |

INNER SURFACE FINISH OPTIONS ON REQUEST *
* minimum order quantity

ANTI-MICROBIAL COATING

| | .99 |
|-----|-----|
| AMC | |

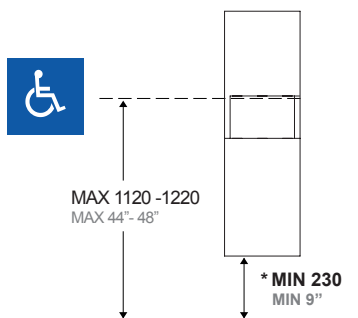

WALL OPENING

Height: 50 1/8" (1273 mm)
Width: 14 1/8" (358 mm)
Depth: 5 1/4" (133 mm)

For more information on compliant location see project guide page 137.

The manufacturer reserves the right to alter, improve and discontinue any features of the product [make changes and improvements in designs and dimensions] without notice.

**GBA.105.0001****SPECIFICATION:**

Convertible combined unit for dispensing paper towel / paper roll and waste unit for recessed installation with final overall dimensions 52" (H) x 16" (W) and 3-63/64" total projection from wall.

GBA.105.0001 includes:

Mounting wall frame in 5/32" (4 mm) thick welded on a all-welded construction in 3/64" (1 mm) thick type 316L stainless steel with powder coated finish for recessed installation.

Bottom front door (waste receptacle) with beautiful non-rounded design made with 1/16" (1,5 mm) and 5/64" (2 mm) thick type 316L stainless steel welded-per-point. Reinforced structure with full height square 19/32" (15 mm) type 316L stainless steel tube. Exposed surfaces of front door have satin finish.

Integrated hinge system to allow the door opening with a minimum gap from the wall (thickness of mounting wall frame).

Unit equipped with a slider door-opening limiter and a concealed closure system which keeps the door closed (not locked). Rectangular hole on side allows access to open the unit with provided key.

Removable leakproof molded waste receptacle in 5/64" (2 mm) black PST (polystyrene) to be order separately with a capacity of 8,02 US gal (30,3 L). Waste receptacle shall be model GBA.105.00WR.00. One key grey RAL 9007 powder coated included.

CONVERTIBLE OPTION (to be ordered separately)

- Upper front door for paper roll shall be item GBA.105.0003 compatible with touchless paper roll dispenser GBA.105.0ETD

OPERATION:

GBA.105.0001 + GBA.105.0003 + GBA.105.0ETD - Use provided key from side hole to open the front door to have access to recessed unit. The sliding door-opening limiter prevents the door for extra-overture which may cause damages to the wall / tiles. Open touchless dispenser with provided plastic key and place recharge of paper roll.

Fits standard size paper rolls up to a maximum of 7-7/8" (200 mm) diameter x 8-21/32" (220 mm) width. The leakproof waste receptacle is removable for servicing: lift slightly and pull forward to remove it from the unit.

INSTALLATION:

Provide framed rough wall opening 50-1/8" height x 14-1/8" width (1273 x 358 mm). Suggested depth to finish face of wall is 5-1/4" (133 mm); minimum recessed depth required is 5-1/8" (130 mm).

Allow clearance for construction features that may protrude into rough wall opening from opposite wall and avoid pipes, vents and conduits.

Mount unit into wall opening and secure with provided fixing screws in 4 mounting holes on the recessed cabinet.

GBA.105.0003**SPECIFICATION:**

Upper front door for convertible paper roll dispenser combined unit with waste receptacle for recessed installation.

GBA.105.0003 includes:

Front door with beautiful non-rounded design made with 1/16" (1,5 mm) and 5/64" (2 mm) thick type 316L stainless steel welded-per-point. Reinforced structure with full height square 19/32" (15 mm) type 316L stainless steel tube. Exposed surfaces of front door have satin finish.

Integrated hinge system to allow the door opening with a minimum gap from the wall (thickness of mounting wall frame).

GBA.105.0ETD**SPECIFICATION:**

Touchless paper roll dispenser compatible with paper rolls up to a maximum of 7-7/8" (200 mm) diameter x 8-21/32" (220 mm) width suitable for item GBA.105.0003, GBA.106.0003.

Overall dimensions 14-5/64" (H) x 12-11/16" (W) x 8-3/4" (D).

Power supply with four type D batteries.

OPERATION:

Open touchless dispenser with provided plastic key and place recharge of paper roll.

Fits standard size paper rolls up to a maximum of 7-7/8" (200 mm) diameter x 8-21/32" (220 mm) width.

GBA.105.00WR**SPECIFICATION:**

Removable leakproof molded waste receptacle in 5/64" (2 mm) black PST (polystyrene) with a capacity of 8,02 US gal (30,3 L) suitable for item GBA.105.0001.

Dimensions 23-1/8" (H) x 10-3/64" (W) x 8-37/64" (D).

OPERATION:

The leakproof waste receptacle is removable for servicing: lift slightly and pull forward to remove it from the unit.

NOTE:

On the satin finish, possible differences in the brushing are the result of the manufacturing process and must be considered acceptable. Minimal welding discontinuities must be considered acceptable.

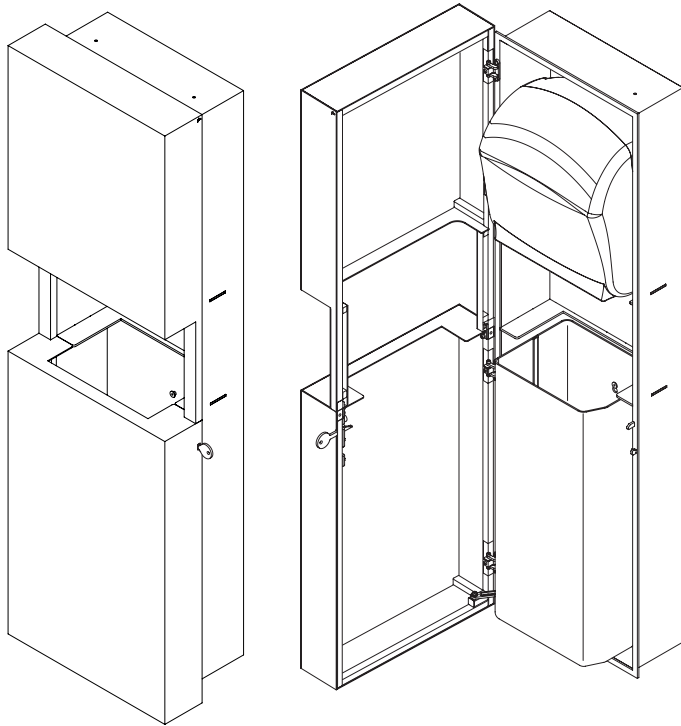

REMOVABLE AUTOMATIC ROLL
DISPENSER

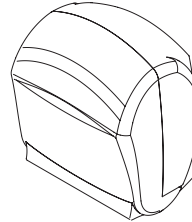

OPENING KEY DETAIL



REMOVABLE WASTE RECEPTACLE

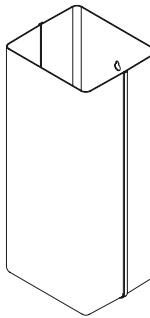

**REMOVABLE AUTOMATIC ROLL
DISPENSER NOT INCLUDED**

ITEM

GBA.105.0ETD.00

KEY INCLUDED

ITEM

GBA.100.0KEY.99

**REMOVABLE WASTE
RECEPTACLE NOT INCLUDED**

ITEM

GBA.105.00WR.00