

Dimensions: center to center

SQUARE GRAB BARS

ITEM	A
GBA.440.Q01U. xx	12"
GBA.440.Q02U. xx	16"
GBA.440.Q03U. xx	18"
GBA.440.Q04U. xx	24"
GBA.440.Q05U. xx	30"
GBA.440.Q06U. xx	32"
GBA.440.Q07U. xx	36"
GBA.440.Q08U. xx	42"
GBA.440.Q09U. xx	48"



.XX STANDARD FINISH

STAINLESS STEEL AISI 316L

POWDER COATED FINISH

.44 SATIN



.31 .38 .39 .32 .40



ANTI-MICROBIAL COATING **A M C**

.99



HORIZONTAL GRAB BAR 90° CORNERS

1-3/16" (30 mm) square profile type 316L stainless steel tube with 1/16" (1,5 mm) thickness welded with 90° corners to 1-3/16" (30 mm) square profile type 316L stainless steel tube with 1/16" (1,5 mm) thickness.
 Square flanges welded from 1/8" (3 mm) thickness and 1/4" (6 mm) type 316L stainless steel sheet are mounted to wall with provided fixing system.
 Stainless steel grub screws are provided to fasten the grab bar to the flanges.
 Clearance between the grab bar and wall is 1-1/2" (38 mm).

STRENGTH

PBA GBA Grab bars can support loads up to 441 pounds (200 kg) if properly installed.
 Complying with accessible design for structural strength (including ADA Accessibility Guidelines – ADAAG – in the U.S.A.), a grab bar should support loads in excess of 250 pounds (113 kg) if properly installed.



SAFETY WARNING

Grab bars must be firmly secured to the anchors and the walls in order for them to support the weight they are designed for. Grab bars alone are not stronger than anchors and walls. In case the grab bar is not securely anchored to the wall, the building owner or maintenance personnel must remove it from service to avoid any accident or injury.

FIXING KITS

Standard fixing kit for concrete wall or drywall is included.
 In case of installation on toilet partition system the single side installation is doable if the material used for the partition panel is plywood (beech or birch) with a minimum thickness of 1". Fixing kit part number is GBA.FIX.0003.00
 Back to back fixing (between two grab bars) or with a backplate is recommended if the material used for partition panel is particleboard. Please specify thickness of panel. Fixing kit part number is GBA.FIX.0002.44

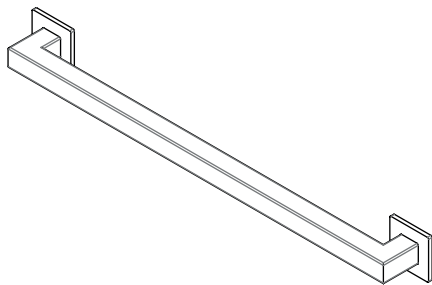

STANDARD FIXING KIT INCLUDED

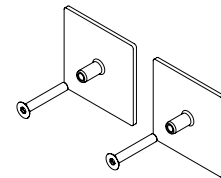

GBA.FIX.0002.44

INSTALLATION

