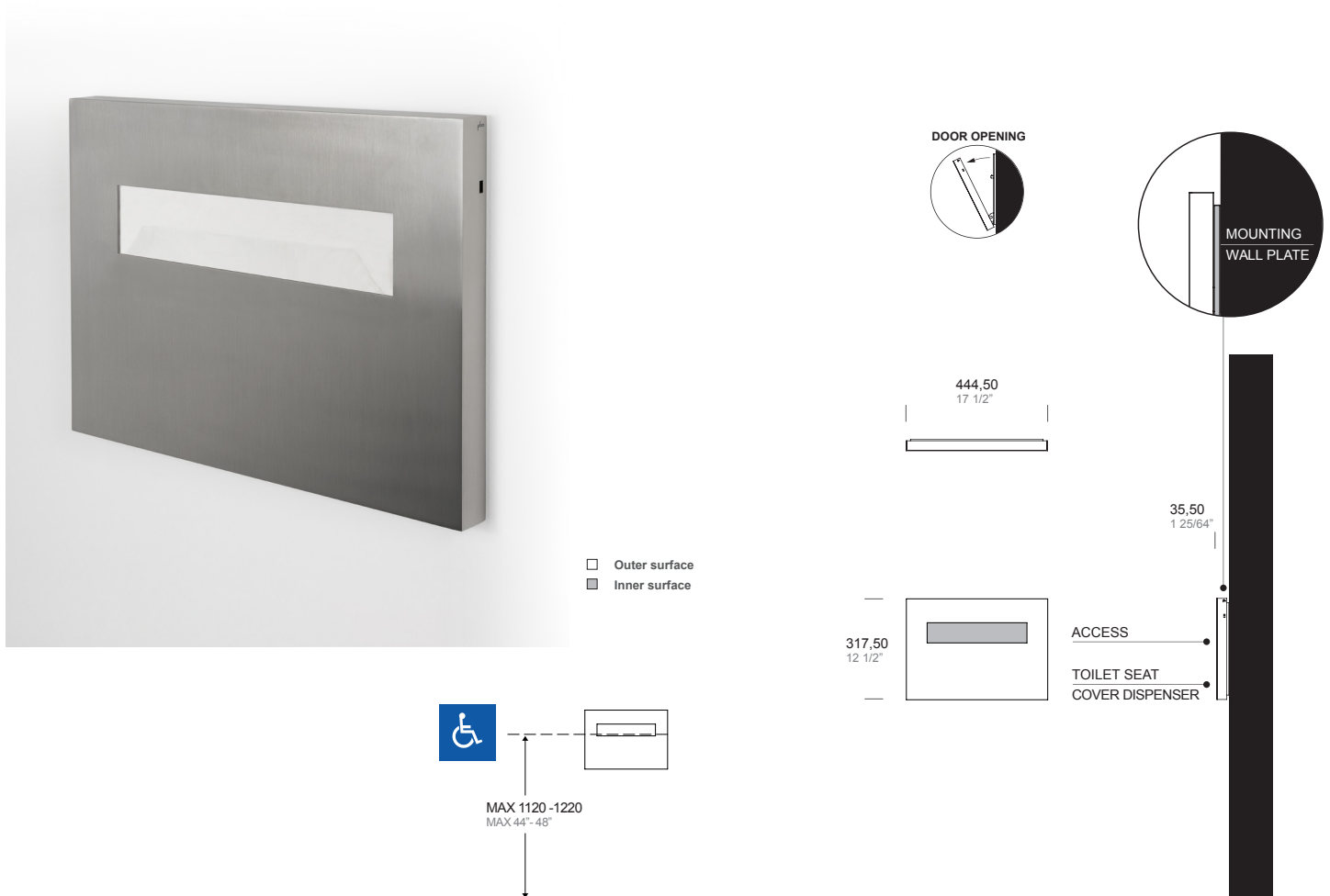

ITEM

GBA.115.0000. xx

TOILET SEAT COVER DISPENSER - SURFACE MOUNTED

**SPECIFICATION:**

Toilet seat cover dispenser for surface mounted installation with overall dimensions 17-1/2" W x 12-1/2" H and 1-25/64" total projection from wall. Mounting plate in 5/32" (4 mm) thick type 316L stainless steel with powder coated finish.

Door frame with beautiful non-rounded design made with 5/64" (2 mm) thick type 316L stainless steel welded-per-point. Reinforced structure with rectangular 1-13/16"x25/35" (30 x 20 mm) type 316L stainless steel tube. Exposed surfaces have satin finish.

Integrated hinge system to allow the door opening with a minimum gap from the wall and concealed closure system which keeps the door closed (not locked). Rectangular hole on side allows access to open the unit with provided key. The unit is equipped with a spring loaded mechanism to adjust the location of the carton box.

One key grey RAL 9007 powder coated included.

OPERATION:

To insert / replace the seat cover box use provided key from side hole to open the door which inclines towards. A built-in rotation limiter prevents the door from extra opening. Place the new carton box and close the unit then remove the key from the hole. If necessary adjust the location of the carton box using the provided hexagonal key (hex.4) by screwing or unscrewing the adjustment screw placed at the bottom hole. Capacity 250 toilet seat covers or one box, it dispenses single or half-fold paper toilet seat covers from each side.

INSTALLATION:

Place unit on wall in desired mounting position and use mounting holes as template to mark holes location.

For plaster or dry wall construction, provide concealed backing to comply with local building codes, then secure with screws (not furnished).

For other wall surfaces provide fiber plugs or expansion shields for use with screws (not furnished).

For partitions with particle-board or other solid core, secure with sheet-metal screws (not furnished).

For hollow-core metal partitions, provide solid backing into which the sheet-metal screws can be secured.

NOTE:

On the satin finish, possible differences in the brushing are the result of the manufacturing process and must be considered acceptable. Minimal welding discontinuities must be considered acceptable.