

LEATHER

Genuine leather is an extremely durable material offering high elasticity, softness and lightness. This fine, natural material may display marks and variations such as lines and wrinkles, and color differences, all signatures that enhance its beauty and excellence.

Certification leather PF:



LEATHER FROM ITALY FULL CYCLE
(UNI EN 16484)



CARBON FOOTPRINT OF PRODUCT
(ISO 14067: 2018)

STANDARD FINISHES

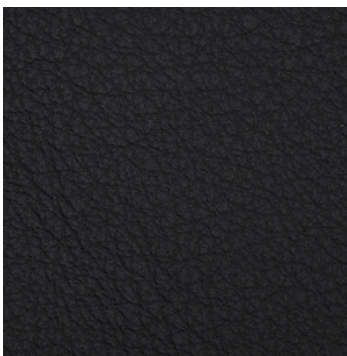

.4H Black PF - Satin stainless steel
.3H Black PF - Bright stainless steel



.4P Brown PF - Satin stainless steel
.3P Brown PF - Bright stainless steel

MAINTENANCE

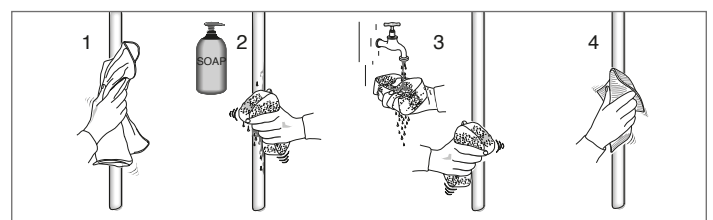
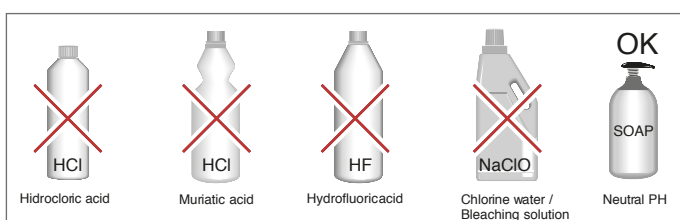

FINISHES ON REQUEST

